

SE Series Dimensional Drawings

Size 16, Dimensional Drawing

Dimensions in inches (mm)

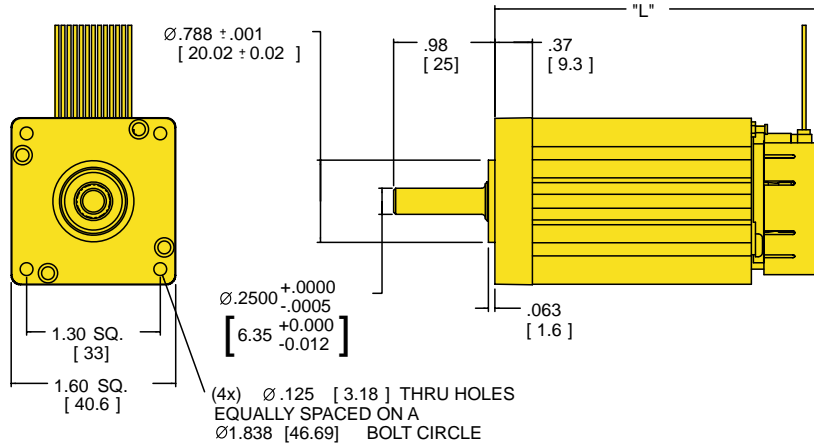

Motor Sizes

Model	Motor Length "L"
SE160	2.67 [67.8]
SE161	3.17 [80.5]
SE162	4.17 [105.9]

Size 23, Dimensional Drawing

Dimensions in inches (mm)

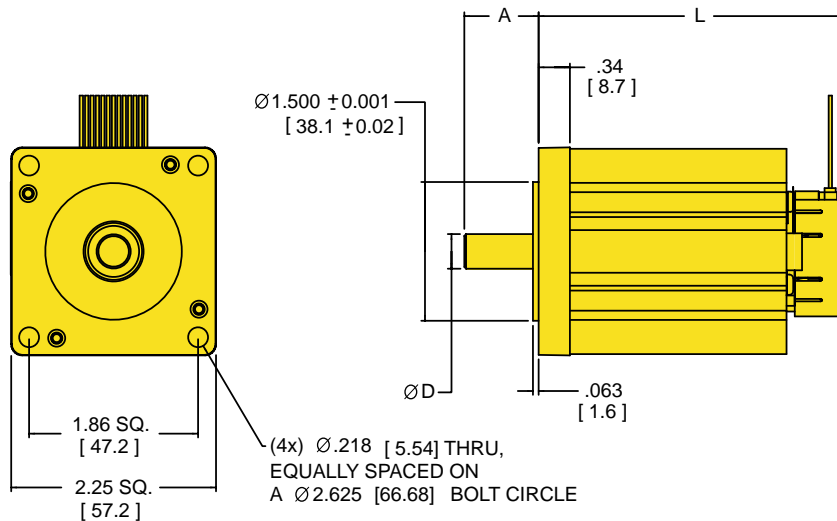

Motor Sizes

Model	Motor Length "L"	Shaft Length "A"	Shaft Diameter "D"
SE230	2.70 [68.6]	.78 [19.8]	.2500 $^{+.0000}_{-.0005}$ [6.350 $^{+0.000}_{-0.013}$]
SE231	3.36 [85.3]	.82 [20.8]	.3750 $^{+.0000}_{-.0005}$ [9.525 $^{+0.000}_{-0.013}$]
SE232	4.36 [110.7]	.82 [20.8]	.3750 $^{+.0000}_{-.0005}$ [9.525 $^{+0.000}_{-0.013}$]
SE233	5.36 [136.1]	.82 [20.8]	.3750 $^{+.0000}_{-.0005}$ [9.525 $^{+0.000}_{-0.013}$]

Servo Motors

