

MOTOR DATA @ 230 VAC (SINE)

MOTOR PARAMETERS	UNITS	VALUE
HORSEPOWER	HP	1.96
KILOWATTS	KW	1.46
MAX. OPERATING SPEED	N. MAX RPM	4100
SPEED @ RATED TORQUE	N RATED RPM	3600
* CONTINUOUS RATED TORQUE @ 3600 RPM	IN-LBS(Nm)	34.4(3.8)
* CONTINUOUS STALL TORQUE	IN-LBS(Nm)	39.0(4.4)
CONTINUOUS LINE CURRENT	AMPS(RMS/φ)	4.5
PEAK TORQUE	IN-LBS(Nm)	137.0(15.5)
PEAK CURRENT	AMPS(RMS/φ)	16.3
MAX. THEORETICAL ACCEL.	RAD/SEC ²	100,000
TORQUE SENSITIVITY	Kt (IN-LBS/AMP(RMS/φ)) / (Nm/AMP(RMS/φ))	8.8(.991)
BACK EMF (LINE TO LINE)	±10% Vrms/Krpm	55.0
D.C. RESISTANCE (P-P)	±10% OHMS	1.9
INDUCTANCE (P-P)	±10% MILLIHENRIES	7.2
ROTOR INERTIA	Jm (IN-LBS-SEC ²) [Kg-M ²]	.00137(.000154)
STATIC FRICTION	Tf (IN-LBS(Nm))	.6(.07)

*25°C AMBIENT WITH A MAXIMUM CASE TEMPERATURE OF 100°C ON MOTOR. MOTOR MOUNTED ON A 10" X 10" X 10" X 1/4" ALUMINUM HEATSINK. THERMOSTAT IN STATOR WINDINGS WILL OPEN IF WINDING TEMPERATURE EXCEEDS 155°C. THIS ALLOWS FOR AN APPROXIMATE +10% HEADROOM IN THE CONTINUOUS TORQUE RATING BEFORE THERMOSTAT OPENS.

MECHANICAL NOTES:

- AXIAL LOAD: 25 LBS MAX
- RADIAL LOAD: 40 LBS MAX @ 1" FROM FACE
- MOTOR SEALED TO IP65.
- MOTOR WEIGHT: 12.2 LBS. [5.5 Kg]
- MOTOR FINISH: BLACK EPOXY
- MOTOR OUTPUT SHAFT: STAINLESS STEEL
- INCHES (MILLIMETERS)

ENCODER: (290-00142)

OH48-1024P6-L6-SV

CONNECTION CHART

MOTOR CONNECTOR:
PT02E-14-5P(027)
(270-00026)

MOTOR WIRE LEADS	WIRE FUNCTION	WIRE COLOR
A	φR	RED
B	φS	BLACK
C	φT	BLUE
D	PE GND	GRN/YEL.
E	-	-

ENCODER/THERM CONNECTOR:
PT02E-14-18P(027)
(270-00024)

ENC/THERM WIRE LEADS	WIRE FUNCTION	WIRE COLOR
T	GROUND	BLACK
K	+5VDC	RED
B	CH A	BLUE
C	CH A	BLUE/BLK
N	CH B	GREEN
P	CH B	GRN/BLK
M	CH Z	YELLOW
U	CH Z	YEL/BLK
E	CH U	BROWN
R	CH U	BRN/BLK
F	CH V	GRAY
S	CH V	GRAY/BLK
G	CH W	WHITE
H	CH W	WHT/BLK
D	GND/CABLE	SHLD
A	THERM	BLACK
L	THERM	BLACK
J	GND	GRN/YEL

MOTOR & HALL POSITION CHART

HALL LEADS	BROWN	GRAY	WHITE
MOTOR LEADS	BLACK respect to RED	RED respect to BLUE	BLUE respect to BLACK
VIEW ON THE OSCILLOSCOPE	AAAA	AAAA	AAAA

*MOTOR ROTATION CCW (COUNTER CLOCKWISE) (LOOKING AT THE FACE OF THE MOTOR)

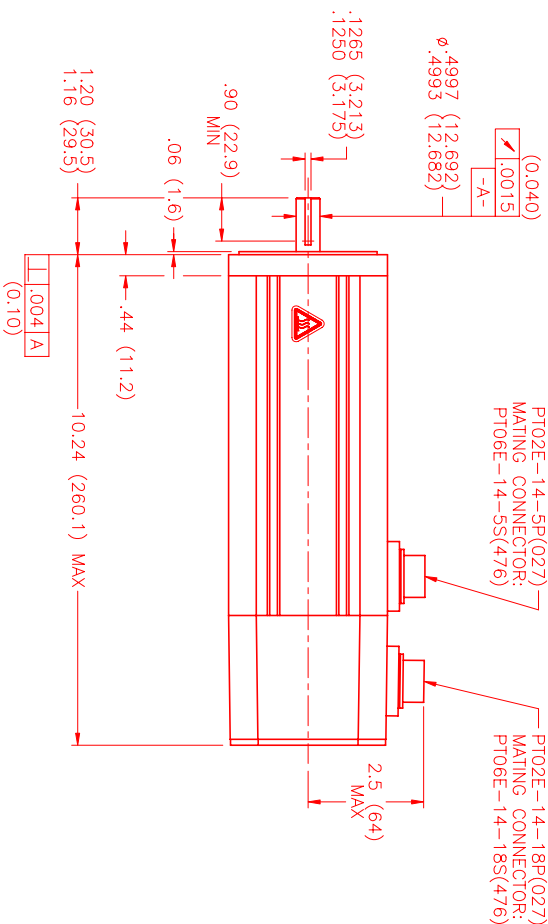
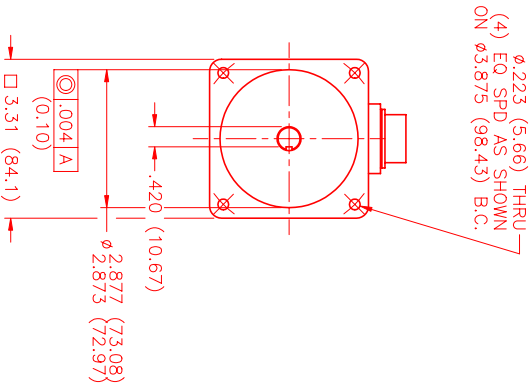
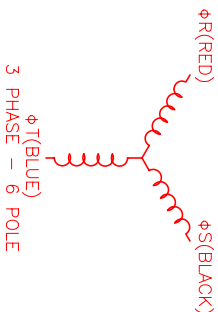

PT02E-14-5P(027) MATING CONNECTOR: PT06E-14-5S(476)

PT02E-14-18P(027) MATING CONNECTOR: PT06E-14-18S(476)

NO.	PART NUMBER	DESCRIPTION	QTY
1	290-00142	Encoder	1
2	OH48-1024P6-L6-SV	Encoder	1
3	290-00142	Encoder	1
4	OH48-1024P6-L6-SV	Encoder	1
5	290-00142	Encoder	1
6	OH48-1024P6-L6-SV	Encoder	1
7	290-00142	Encoder	1
8	OH48-1024P6-L6-SV	Encoder	1
9	290-00142	Encoder	1
10	OH48-1024P6-L6-SV	Encoder	1
11	290-00142	Encoder	1
12	OH48-1024P6-L6-SV	Encoder	1
13	290-00142	Encoder	1
14	OH48-1024P6-L6-SV	Encoder	1
15	290-00142	Encoder	1
16	OH48-1024P6-L6-SV	Encoder	1
17	290-00142	Encoder	1
18	OH48-1024P6-L6-SV	Encoder	1
19	290-00142	Encoder	1
20	OH48-1024P6-L6-SV	Encoder	1
21	290-00142	Encoder	1
22	OH48-1024P6-L6-SV	Encoder	1
23	290-00142	Encoder	1
24	OH48-1024P6-L6-SV	Encoder	1
25	290-00142	Encoder	1
26	OH48-1024P6-L6-SV	Encoder	1
27	290-00142	Encoder	1
28	OH48-1024P6-L6-SV	Encoder	1
29	290-00142	Encoder	1
30	OH48-1024P6-L6-SV	Encoder	1
31	290-00142	Encoder	1
32	OH48-1024P6-L6-SV	Encoder	1
33	290-00142	Encoder	1
34	OH48-1024P6-L6-SV	Encoder	1
35	290-00142	Encoder	1
36	OH48-1024P6-L6-SV	Encoder	1
37	290-00142	Encoder	1
38	OH48-1024P6-L6-SV	Encoder	1
39	290-00142	Encoder	1
40	OH48-1024P6-L6-SV	Encoder	1
41	290-00142	Encoder	1
42	OH48-1024P6-L6-SV	Encoder	1
43	290-00142	Encoder	1
44	OH48-1024P6-L6-SV	Encoder	1
45	290-00142	Encoder	1
46	OH48-1024P6-L6-SV	Encoder	1
47	290-00142	Encoder	1
48	OH48-1024P6-L6-SV	Encoder	1
49	290-00142	Encoder	1
50	OH48-1024P6-L6-SV	Encoder	1
51	290-00142	Encoder	1
52	OH48-1024P6-L6-SV	Encoder	1
53	290-00142	Encoder	1
54	OH48-1024P6-L6-SV	Encoder	1
55	290-00142	Encoder	1
56	OH48-1024P6-L6-SV	Encoder	1
57	290-00142	Encoder	1
58	OH48-1024P6-L6-SV	Encoder	1
59	290-00142	Encoder	1
60	OH48-1024P6-L6-SV	Encoder	1
61	290-00142	Encoder	1
62	OH48-1024P6-L6-SV	Encoder	1
63	290-00142	Encoder	1
64	OH48-1024P6-L6-SV	Encoder	1
65	290-00142	Encoder	1
66	OH48-1024P6-L6-SV	Encoder	1
67	290-00142	Encoder	1
68	OH48-1024P6-L6-SV	Encoder	1
69	290-00142	Encoder	1
70	OH48-1024P6-L6-SV	Encoder	1
71	290-00142	Encoder	1
72	OH48-1024P6-L6-SV	Encoder	1
73	290-00142	Encoder	1
74	OH48-1024P6-L6-SV	Encoder	1
75	290-00142	Encoder	1
76	OH48-1024P6-L6-SV	Encoder	1
77	290-00142	Encoder	1
78	OH48-1024P6-L6-SV	Encoder	1
79	290-00142	Encoder	1
80	OH48-1024P6-L6-SV	Encoder	1
81	290-00142	Encoder	1
82	OH48-1024P6-L6-SV	Encoder	1
83	290-00142	Encoder	1
84	OH48-1024P6-L6-SV	Encoder	1
85	290-00142	Encoder	1
86	OH48-1024P6-L6-SV	Encoder	1
87	290-00142	Encoder	1
88	OH48-1024P6-L6-SV	Encoder	1
89	290-00142	Encoder	1
90	OH48-1024P6-L6-SV	Encoder	1
91	290-00142	Encoder	1
92	OH48-1024P6-L6-SV	Encoder	1
93	290-00142	Encoder	1
94	OH48-1024P6-L6-SV	Encoder	1
95	290-00142	Encoder	1
96	OH48-1024P6-L6-SV	Encoder	1
97	290-00142	Encoder	1
98	OH48-1024P6-L6-SV	Encoder	1
99	290-00142	Encoder	1
100	OH48-1024P6-L6-SV	Encoder	1

REV.	DESCRIPTION	DATE	APP.
PRELIMINARY		10/11/01	AJS

DATE	DESCRIPTION	REV.
10/11/01	REVISIONS	1

NO.	PART NUMBER	DESCRIPTION	QTY
1	290-00142	Encoder	1
2	OH48-1024P6-L6-SV	Encoder	1
3	290-00142	Encoder	1
4	OH48-1024P6-L6-SV	Encoder	1
5	290-00142	Encoder	1
6	OH48-1024P6-L6-SV	Encoder	1
7	290-00142	Encoder	1
8	OH48-1024P6-L6-SV	Encoder	1
9	290-00142	Encoder	1
10	OH48-1024P6-L6-SV	Encoder	1
11	290-00142	Encoder	1
12	OH48-1024P6-L6-SV	Encoder	1
13	290-00142	Encoder	1
14	OH48-1024P6-L6-SV	Encoder	1
15	290-00142	Encoder	1
16	OH48-1024P6-L6-SV	Encoder	1
17	290-00142	Encoder	1
18	OH48-1024P6-L6-SV	Encoder	1
19	290-00142	Encoder	1
20	OH48-1024P6-L6-SV	Encoder	1
21	290-00142	Encoder	1
22	OH48-1024P6-L6-SV	Encoder	1
23	290-00142	Encoder	1
24	OH48-1024P6-L6-SV	Encoder	1
25	290-00142	Encoder	1
26	OH48-1024P6-L6-SV	Encoder	1
27	290-00142	Encoder	1
28	OH48-1024P6-L6-SV	Encoder	1
29	290-00142	Encoder	1
30	OH48-1024P6-L6-SV	Encoder	1
31	290-00142	Encoder	1
32	OH48-1024P6-L6-SV	Encoder	1
33	290-00142	Encoder	1
34	OH48-1024P6-L6-SV	Encoder	1
35	290-00142	Encoder	1
36	OH48-1024P6-L6-SV	Encoder	1
37	290-00142	Encoder	1
38	OH48-1024P6-L6-SV	Encoder	1
39	290-00142	Encoder	1
40	OH48-1024P6-L6-SV	Encoder	1
41	290-00142	Encoder	1
42	OH48-1024P6-L6-SV	Encoder	1
43	290-00142	Encoder	1
44	OH48-1024P6-L6-SV	Encoder	1
45	290-00142	Encoder	1
46	OH48-1024P6-L6-SV	Encoder	1
47	290-00142	Encoder	1
48	OH48-1024P6-L6-SV	Encoder	1
49	290-00142	Encoder	1
50	OH48-1024P6-L6-SV	Encoder	1
51	290-00142	Encoder	1
52	OH48-1024P6-L6-SV	Encoder	1
53	290-00142	Encoder	1
54	OH48-1024P6-L6-SV	Encoder	1
55	290-00142	Encoder	1
56	OH48-1024P6-L6-SV	Encoder	1
57	290-00142	Encoder	1
58	OH48-1024P6-L6-SV	Encoder	1
59	290-00142	Encoder	1
60	OH48-1024P6-L6-SV	Encoder	1
61	290-00142	Encoder	1
62	OH48-1024P6-L6-SV	Encoder	1
63	290-00142	Encoder	1
64	OH48-1024P6-L6-SV	Encoder	1
65	290-00142	Encoder	1
66	OH48-1024P6-L6-SV	Encoder	1
67	290-00142	Encoder	1
68	OH48-1024P6-L6-SV	Encoder	1
69	290-00142	Encoder	1
70	OH48-1024P6-L6-SV	Encoder	1
71	290-00142	Encoder	1
72	OH48-1024P6-L6-SV	Encoder	1
73	290-00142	Encoder	1
74	OH48-1024P6-L6-SV	Encoder	1
75	290-00142	Encoder	1
76	OH48-1024P6-L6-SV	Encoder	1
77	290-00142	Encoder	1
78	OH48-1024P6-L6-SV	Encoder	1
79	290-00142	Encoder	1
80	OH48-1024P6-L6-SV	Encoder	1
81	290-00142	Encoder	1
82	OH48-1024P6-L6-SV	Encoder	1
83	290-00142	Encoder	1
84	OH48-1024P6-L6-SV	Encoder	1
85	290-00142	Encoder	1
86	OH48-1024P6-L6-SV	Encoder	1
87	290-00142	Encoder	1
88	OH48-1024P6-L6-SV		