

MOTOR DATA @ 230 VAC (SINE)

MOTOR PARAMETERS	UNITS	VALUE
HORSEPOWER	HP RATED	4.4
KILOWATTS	KW RATED	3.3
MAX. OPERATING SPEED	N MAX	2700
SPEED @ RATED TORQUE	N RATED	2400
* CONTINUOUS RATED TORQUE @ 2400 RPM	IN-LBS[Nm]	115.0[13.0]
* CONTINUOUS STALL TORQUE	IN-LBS[Nm]	130.0[14.7]
CONTINUOUS LINE CURRENT	AMPS[RMS/Φ]	11.3
PEAK TORQUE	IN-LBS[Nm]	390.0[43.9]
PEAK CURRENT	AMPS[RMS/Φ]	33.9
MAX. THEORETICAL ACCEL.	RAD/SEC ²	36,792
TORQUE SENSITIVITY	Kt [IN-LBS/AMPERE/RMS/Φ]/[Nm/AMPERE/RMS/Φ]	11.21[1.26]
BACK EMF (LINE TO LINE)	Vrms/Krpm	70.0
D.C. RESISTANCE (P-P)	OHMS	4.7
INDUCTANCE (P-P)	MILLIHENRIES	.66
ROTOR INERTIA	Jm [IN-LBS-SEC ²]/[Kg-M ²]	.0106[.00119]
STATIC FRICTION	Tf [IN-LBS]/[Nm]	2.4[.27]

*25°C AMBIENT WITH A MAXIMUM CASE TEMPERATURE OF 100°C ON MOTOR. MOTOR MOUNTED ON A 12" X 12" X 1/2" ALUMINUM HEATSINK. THERMOSTAT IN STATOR WINDINGS WILL OPEN IF WINDING TEMPERATURE EXCEEDS 155°C. THIS ALLOWS FOR AN APPROXIMATE +10% HEADROOM IN THE CONTINUOUS TORQUE RATING BEFORE THERMOSTAT OPENS.

MECHANICAL NOTES:

1. AXIAL LOAD: 50 LBS MAX
2. RADIAL LOAD: 150 LBS MAX @ 1" FROM FACE
3. MOTOR SEALED TO IP65.
4. MOTOR WEIGHT: 33 LBS. [15.0 Kg]
5. MOTOR FINISH: BLACK EPOXY
6. MOTOR OUTPUT SHAFT: STAINLESS STEEL
7. MILLIMETERS (INCHES)

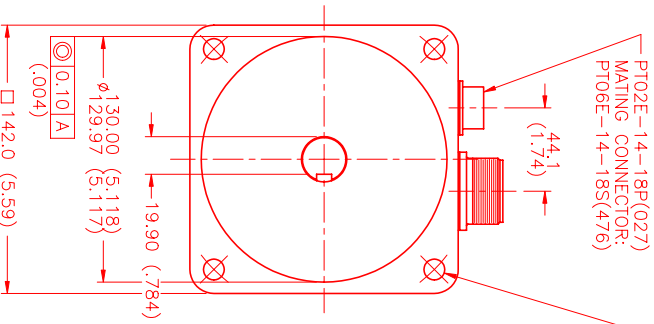

PTO2E-14-18P(027)
MATING CONNECTOR:
PT06E-14-18S(476)

φ11.00 (.433) THRU
(4) EQ. SPD AS SHOWN
ON φ165.00 (6.496) B.C.

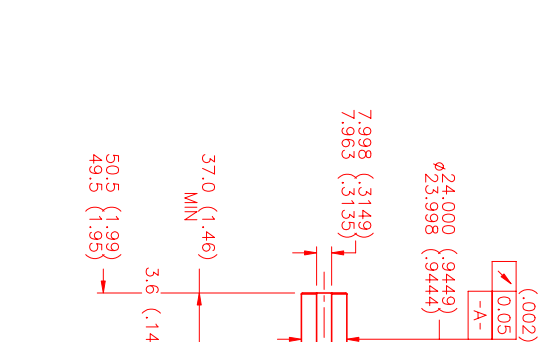

CONNECTION CHART

MOTOR WIRE LEADS	WIRE FUNCTION	WIRE COLOR
A	ΦR	RED
B	ΦS	BLACK
C	ΦT	BLUE
D	PE_GND	GRN/YEL

RESOLVER/THERM CONNECTOR:

MOTOR WIRE LEADS	RES/THERM WIRE LEADS
A	U
B	V
C	W
D	X
P	Y
A	Z
B	AA
C	AB
J	AC
K	AD
L	AE
M	AF
T	AG

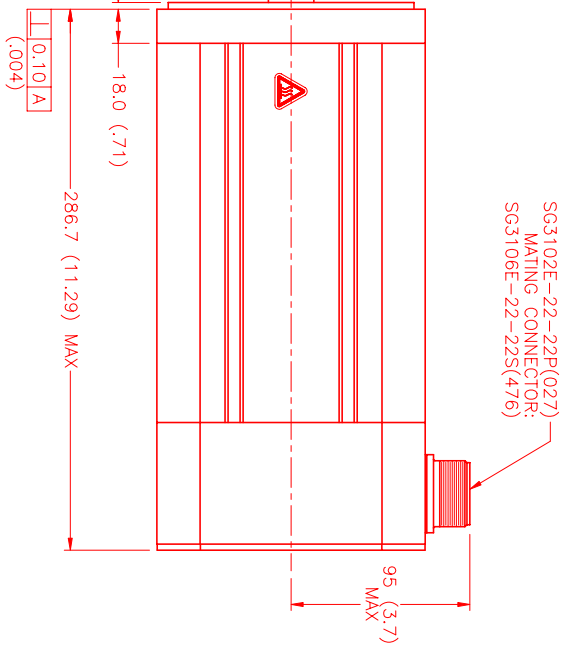

REV	DESCRIPTION	DATE	APP'D
PRELIMINARY		1/29/02	MS

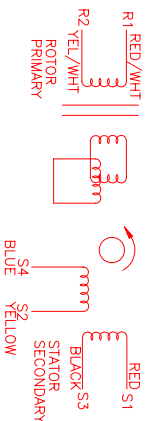
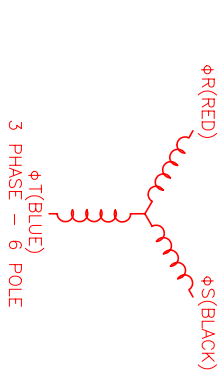

SCHEMATIC DRAWING FOR
BRUSHLESS RESOLVER
RESOLVER IS SET FOR A TBF-*/R AMPLIFIER

NO.	PART NUMBER	DESCRIPTION	QTY.
UNLESS SPECIFIED			
DESIGN	MTS	MTS Systems Corporation	
DATE	1/29/02		
SCALE	1/2:1		
APPROVED			