

**MOTOR DATA @ 480 VAC (SINE)**

MOTOR PARAMETERS	UNITS	VALUE
MOTOR HORSEPOWER	HP	2.1
KILOWATTS	KW	1.6
MAX. OPERATING SPEED	N MAX RPM	4200
SPEED @ RATED TORQUE	N RATED RPM	3000
* CONTINUOUS RATED TORQUE @ 3000 RPM	IN-LBS(Nm)	45.0(6.1)
* CONTINUOUS STALL TORQUE	IN-LBS(Nm)	54.0(6.1)
CONTINUOUS LINE CURRENT	AMPS(RMS/Φ)	3.1
PEAK CURRENT	IN-LBS(Nm)	189.1(21.3)
MAX. THEORETICAL ACCEL	AMPS(RMS/Φ)	10.8
TORQUE SENSITIVITY	RD/SEC*	54.028
BACK EMF (LINE TO LINE)	Kt IN-LBS/AMPS/Φ(Nm/AMPS/Φ)	17.48(1.97)
D.C. RESISTANCE (P-P)	Vrms/Krpm	110.0
INDUCTANCE (P-P)	OHMS	3.2
ROTOR INERTIA	MILLIHENRIES	24.0
STATIC FRICTION	μm IN-LBS-SEC <sup>2</sup> (Kg-M <sup>2</sup> )	0.00035(0.00039)
	Tf IN-LBS(Nm)	1.0(0.11)

\*25°C AMBIENT WITH A MAXIMUM CASE TEMPERATURE OF 100°C ON MOTOR. MOTOR MOUNTED ON A 12" X 12" X 1/2" ALUMINUM HEATSINK. THERMOSTAT IN STATOR WINDINGS WILL OPEN IF WINDING TEMPERATURE EXCEEDS 155°C. THIS ALLOWS FOR AN APPROXIMATE +10% HEADROOM IN THE CONTINUOUS TORQUE RATING BEFORE THERMOSTAT OPENS.

- MECHANICAL NOTES:**
1. AXIAL LOAD: 50 LBS MAX
  2. RADIAL LOAD: 100 LBS MAX @ 1" FROM FACE
  3. MOTOR SEALED TO IP65.
  4. MOTOR WEIGHT: 15.6 LBS. [ 7.1 Kg]
  5. MOTOR FINISH: BLACK EPOXY
  6. MOTOR OUTPUT SHAFT: STAINLESS STEEL
  7. INCHES (MILLIMETERS)

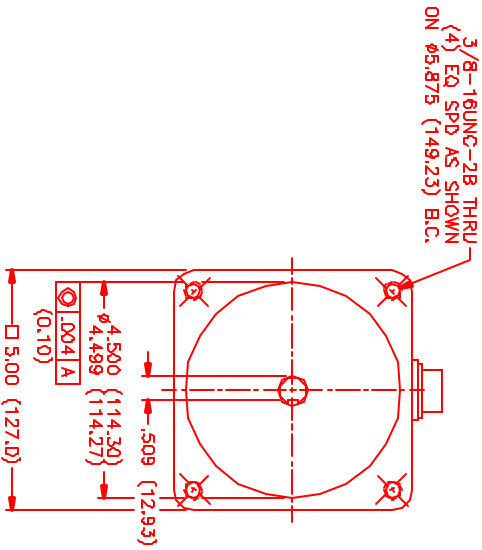

**CONNECTION CHART**  
MOTOR CONNECTOR: PT02E-14-5P(027) (270-D0026)

MOTOR WIRE LEADS	WIRE COLOR	WIRE COLOR
PIN A	4P	RED
B	4S	BLACK
C	4T	BLUE
D	PE GND	GRN/YEL
E	-	-

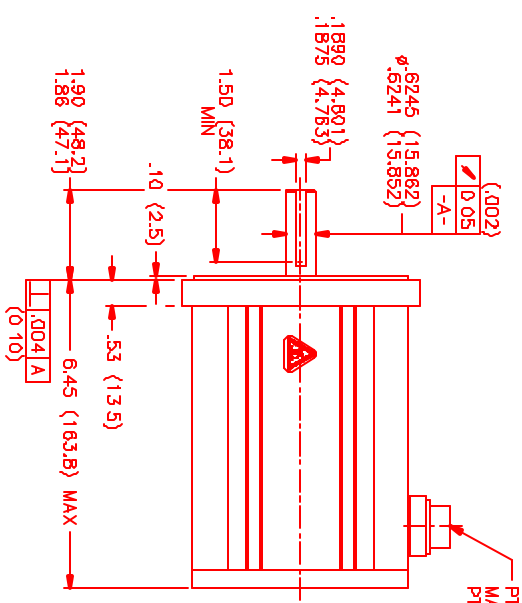

PT02E-14-5P(027) MATING CONNECTOR: PT06E-14-5S(476)

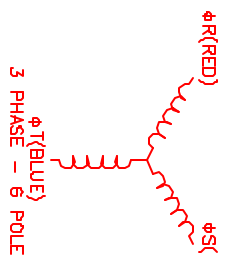

REV	DESCRIPTION	DATE	APP'D.
1	PRELIMINARY	11/7/01	MS

NO.	PART NUMBER	DESCRIPTION	QTY.
1	MPS Systems Corporation Automation Division		

TITLE	DATE	REV
PT02E-14-5P(027) MOTOR	11/7/01	MS