

TORQUE RANGE: 12-39 IN-LBS
1.4-4.4 Nm
Motor Data (Trap)

| Motor Parameters | | Units | 890ATG**** | 890BTG**** | 891ATG**** | 891BTG**** | |
|--|----------|--|-------------------|-------------------|-------------------|-------------------|------|
| Horsepower | Hp Rated | Hp | 0.51 | 0.38 | 0.82 | 0.55 | |
| Kilowatts | KW Rated | KW | 0.38 | 0.29 | 0.62 | 0.41 | |
| Max. Operating Speed | N Max | RPM | 5000 | 3000 | 5000 | 3000 | |
| Speed @ Rated Torque | N Rated | RPM | 4000 | 2400 | 4000 | 2400 | |
| *Continuous Rated Torque @ Rated Speed | | IN-LBS[Nm] | 8.0[.90] | 10.0[1.10] | 13.0[1.47] | 14.5[1.64] | |
| *Continuous Stall Torque | | IN-LBS[Nm] | 12.0[1.40] | 12.0[1.40] | 16.0[1.81] | 16.0[1.81] | |
| Continuous Line Current | | AMPS | 3.0 | 2.0 | 3.8 | 1.9 | |
| Peak Torque | Tpk | IN-LBS[Nm] | 36.0[4.1] | 36.0[4.1] | 58.8[6.64] | 58.8[6.64] | |
| Peak Current | | AMPS | 9.0 | 6.0 | 14.0 | 7.0 | |
| Max. Theoretical Accel. | | RAD/SEC ² | 84,309 | 84,309 | 95,610 | 95,610 | |
| Torque Sensitivity | Kt | IN-LBS/AMP[Nm/AMP] | 4.2[.48] | 6.2[.70] | 4.2[0.48] | 8.4[0.96] | |
| Back EMF (Line to Line) | ±10% | Vrms/Krpm | 37.0 | 55.0 | 37.6 | 75.2 | |
| D.C. Resistance (P-P) | | ±10% | OHMS | 11.1 | 27 | 3.9 | 15.4 |
| Inductance (P-P) | | ±10% | MILLIHENRIES | 24.0 | 58 | 10.4 | 39.6 |
| Rotor Inertia | Jm | IN-LBS-SEC ² [Kg-M ²] | .000427[.0000482] | .000427[.0000482] | .000615[.0000693] | .000615[.0000693] | |
| Static Friction | Tf | IN-LBS[Nm] | 0.3[0.03] | 0.3[0.03] | 0.4[0.05] | 0.4[0.05] | |
| Motor Weight | | LBS[Kg] | 6.5[2.9] | 6.5[2.9] | 7.8[3.5] | 7.8[3.5] | |
| Line Voltage | | VAC | 230 | 230 | 230 | 230 | |

| Motor Parameters | | Units | 892ATG**** | 892BTG**** | 893ATG**** | 893BTG**** | |
|--|----------|--|-------------------|-------------------|-----------------|-----------------|------|
| Horsepower | Hp Rated | Hp | 1.62 | 1.05 | 1.96 | 1.10 | |
| Kilowatts | KW Rated | KW | 1.20 | 0.78 | 1.46 | 0.85 | |
| Max. Operating Speed | N Max | RPM | 5000 | 3000 | 4100 | 2000 | |
| Speed @ Rated Torque | N Rated | RPM | 4000 | 2400 | 3600 | 1500 | |
| *Continuous Rated Torque @ Rated Speed | | IN-LBS[Nm] | 25.5[2.9] | 27.5[3.1] | 34.4[3.8] | 36.0[4.0] | |
| *Continuous Stall Torque | | IN-LBS[Nm] | 30.0[3.4] | 30.0[3.4] | 39.0[4.4] | 39.0[4.4] | |
| Continuous Line Current | | AMPS | 7.3 | 3.7 | 6.3 | 3.0 | |
| Peak Torque | Tpk | IN-LBS[Nm] | 105.0[11.9] | 105.0[11.9] | 137.0[15.5] | 137.0[15.5] | |
| Peak Current | | AMPS | 26.8 | 13.6 | 23.1 | 11.1 | |
| Max. Theoretical Accel. | | RAD/SEC ² | 105,954 | 105,954 | 100,000 | 100,000 | |
| Torque Sensitivity | Kt | IN-LBS/AMP[Nm/AMP] | 4.1[0.47] | 8.2[0.94] | 6.2[0.7] | 12.4[1.4] | |
| Back EMF (Line to Line) | ±10% | Vrms/Krpm | 36.6 | 73.2 | 55.0 | 110.0 | |
| D.C. Resistance (P-P) | | ±10% | OHMS | 1.5 | 6.0 | 1.9 | 7.7 |
| Inductance (P-P) | | ±10% | MILLIHENRIES | 5.1 | 20.2 | 7.5 | 29.1 |
| Rotor Inertia | Jm | IN-LBS-SEC ² [Kg-M ²] | .000991[.0001116] | .000991[.0001116] | .00137[.000154] | .00137[.000154] | |
| Static Friction | Tf | IN-LBS[Nm] | 0.5[0.06] | 0.5[0.06] | 0.6[0.07] | 0.6[0.07] | |
| Motor Weight | | LBS[Kg] | 10.4[4.7] | 10.4[4.7] | 14.0[6.0] | 14.0[6.0] | |
| Line Voltage | | VAC | 230 | 230 | 230 | 230 | |

Brake Info:

Min. Holding Torque: 60 IN-LBS
Input Voltage: 24VDC
Current: 2.2 AMPS
Inertia: .00015 IN-LB-SEC²
Weight Adder: 2.2 LBS

*25° C Ambient with a maximum case temperature of 100° C on motor. Motor mounted on a 10" x 10" x 1/4" aluminum heatsink. Thermostat in stator windings will open if winding temperature exceeds 155° C. This allows +10% headroom in the continuous torque rating before thermostat opens.

Mechanical Notes:

1. Axial Load: 25 LBS. Max.
2. Radial Load: 40 LBS. Max. @ 1" from face
3. Motor sealed to IP65

TORQUE RANGE: 12-39 IN-LBS
1.4-4.4 Nm
Motor Data (Sine)

| Motor Parameters | | Units | 890ASG**** | 890BSG**** | 891ASG**** | 891BSG**** |
|---|----------|--|-------------------|-------------------|-------------------|-------------------|
| Horsepower | Hp Rated | Hp | 0.51 | 0.38 | 0.82 | 0.55 |
| Kilowatts | KW Rated | KW | 0.38 | 0.29 | 0.62 | 0.41 |
| Max. Operating Speed | N Max | RPM | 5000 | 3000 | 5000 | 3000 |
| Speed @ Rated Torque | N Rated | RPM | 4000 | 2400 | 4000 | 2400 |
| *Continuous Rated Torque @ Rated Speed | | IN-LBS[Nm] | 8.0[.90] | 10.0[1.10] | 13.0[1.47] | 14.5[1.64] |
| *Continuous Stall Torque | | IN-LBS[Nm] | 12.0[1.40] | 12.0[1.40] | 16.0[1.81] | 16.0[1.81] |
| Continuous Line Current | | AMPS(RMS/φ) | 2.1 | 1.4 | 2.7 | 1.3 |
| Peak Torque | Tpk | IN-LBS[Nm] | 36.0[4.1] | 36.0[4.1] | 58.8[6.64] | 58.8[6.64] |
| Peak Current | | AMPS(RMS/φ) | 6.4 | 4.2 | 9.9 | 4.9 |
| Max. Theoretical Accel. | | RAD/SEC ² | 84,309 | 84,309 | 95,610 | 95,610 |
| Torque Sensitivity | Kt | IN-LBS/AMP(RMS/φ)[Nm/AMP(RMS/φ)] | 5.9[.67] | 8.8[.99] | 5.9[.67] | 11.9[1.34] |
| Back EMF (Line to Line) | ±10% | Vrms/Krpm | 37.0 | 55.0 | 37.6 | 75.2 |
| D.C. Resistance (P-P) | | ±10% OHMS | 11.1 | 27 | 3.9 | 15.4 |
| Inductance (P-P) | | ±10% MILLIHENRIES | 24.0 | 58 | 10.4 | 39.6 |
| Rotor Inertia | Jm | IN-LBS-SEC ² [Kg-M ²] | .000427[.0000482] | .000427[.0000482] | .000615[.0000693] | .000615[.0000693] |
| Static Friction | Tf | IN-LBS[Nm] | 0.3[0.03] | 0.3[0.03] | 0.4[0.05] | 0.4[0.05] |
| Motor Weight | | LBS[Kg] | 6.5[2.9] | 6.5[2.9] | 7.8[3.5] | 7.8[3.5] |
| Line Voltage | | VAC | 230 | 230 | 230 | 230 |

| Motor Parameters | | Units | 892ASG**** | 892BSG**** | 893ASG**** | 893BSG**** |
|---|----------|--|-------------------|-------------------|-----------------|-----------------|
| Horsepower | Hp Rated | Hp | 1.62 | 1.05 | 1.96 | 1.10 |
| Kilowatts | KW Rated | KW | 1.20 | 0.78 | 1.46 | 0.85 |
| Max. Operating Speed | N Max | RPM | 5000 | 3000 | 4100 | 2000 |
| Speed @ Rated Torque | N Rated | RPM | 4000 | 2400 | 3600 | 1500 |
| *Continuous Rated Torque @ Rated Speed | | IN-LBS[Nm] | 25.5[2.9] | 27.5[3.1] | 34.4[3.8] | 36.0[4.0] |
| *Continuous Stall Torque | | IN-LBS[Nm] | 30.0[3.4] | 30.0[3.4] | 39.0[4.4] | 39.0[4.4] |
| Continuous Line Current | | AMPS(RMS/φ) | 5.2 | 2.6 | 4.5 | 2.1 |
| Peak Torque | Tpk | IN-LBS[Nm] | 105.0[11.9] | 105.0[11.9] | 137.0[15.5] | 137.0[15.5] |
| Peak Current | | AMPS(RMS/φ) | 18.9 | 9.6 | 16.3 | 7.9 |
| Max. Theoretical Accel. | | RAD/SEC ² | 105,954 | 105,954 | 100,000 | 100,000 |
| Torque Sensitivity | Kt | IN-LBS/AMP(RMS/φ)[Nm/AMP(RMS/φ)] | 5.8[.66] | 11.6[1.31] | 8.8[.99] | 17.5[1.98] |
| Back EMF (Line to Line) | ±10% | Vrms/Krpm | 36.6 | 73.2 | 55.0 | 110.0 |
| D.C. Resistance (P-P) | | ±10% OHMS | 1.5 | 6.0 | 1.9 | 7.7 |
| Inductance (P-P) | | ±10% MILLIHENRIES | 5.1 | 20.2 | 7.5 | 29.1 |
| Rotor Inertia | Jm | IN-LBS-SEC ² [Kg-M ²] | .000991[.0001116] | .000991[.0001116] | .00137[.000154] | .00137[.000154] |
| Static Friction | Tf | IN-LBS[Nm] | 0.5[0.06] | 0.5[0.06] | 0.6[0.07] | 0.6[0.07] |
| Motor Weight | | LBS[Kg] | 10.4[4.7] | 10.4[4.7] | 14.0[6.0] | 14.0[6.0] |
| Line Voltage | | VAC | 230 | 230 | 230 | 230 |

Brake Info:

Min. Holding Torque: 60 IN-LBS
Input Voltage: 24VDC
Current : 2.2 AMPS
Inertia: .00015 IN-LB-SEC²
Weight Adder: 2.2 LBS

*25° C Ambient with a maximum case temperature of 100° C on motor. Motor mounted on a 10" x 10" x 1/4" aluminum heatsink. Thermostat in stator windings will open if winding temperature exceeds 155° C. This allows +10% headroom in the continuous torque rating before thermostat opens.

Mechanical Notes:

1. Axial Load: 25 LBS. Max.
2. Radial Load: 40 LBS. Max. @ 1" from face
3. Motor sealed to IP65

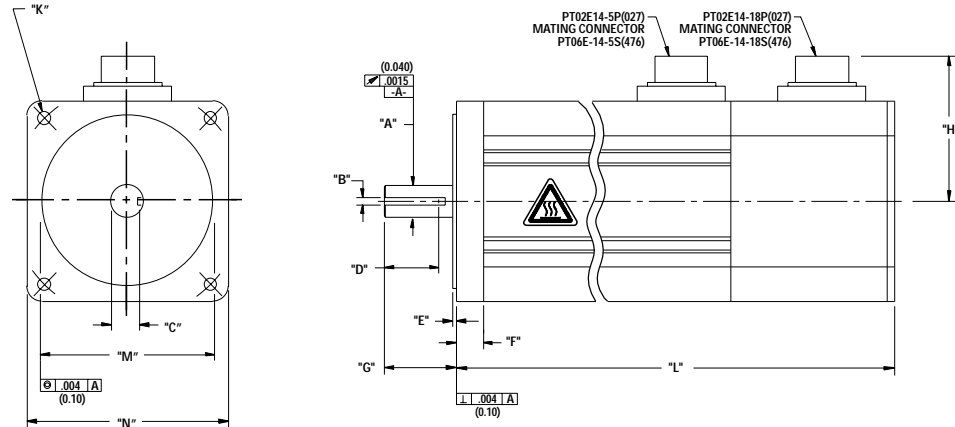

3" (89) English and Metric Connectorized Termination-Option 1 Motors

| Model | "A" | "B" | "C" | "D" | "E" | "F" | "G" |
|---------------|------------------------------------|--------------------------------|--------------|----------------|-----------|------------|----------------------------|
| MPM890***6*** | Ø .4997 (12.692) .4993 (12.682) | .1265 (3.213) .1250 (3.175) | .420 (10.67) | .90 (22.9) Min | .06 (1.6) | .44 (11.2) | 1.20 (30.5) 1.16 (29.5) |
| MPM890***7*** | Ø 14.000 (.5512) 13.985 (.5508) | 5.08 (.200) 5.00 (.197) | 10.90 (.429) | 20.0 (.79) Min | 3.0 (.12) | 11.2 (.44) | 30.5 (1.20) 29.5 (1.16) |
| MPM891***6*** | Ø .4997 (12.692) .4993 (12.682) | .1265 (3.213) .1250 (3.175) | .420 (10.67) | .90 (22.9) Min | .06 (1.6) | .44 (11.2) | 1.20 (30.5) 1.16 (29.5) |
| MPM891***7*** | Ø 14.000 (.5512) 13.985 (.5508) | 5.08 (.200) 5.00 (.197) | 10.90 (.429) | 20.0 (.79) Min | 3.0 (.12) | 11.2 (.44) | 30.5 (1.20) 29.5 (1.16) |
| MPM892***6*** | Ø .4997 (12.692) .4993 (12.682) | .1265 (3.213) .1250 (3.175) | .420 (10.67) | .90 (22.9) Min | .06 (1.6) | .44 (11.2) | 1.20 (30.5) 1.16 (29.5) |
| MPM892***7*** | Ø 14.000 (.5512) 13.985 (.5508) | 5.08 (.200) 5.00 (.197) | 10.90 (.429) | 20.0 (.79) Min | 3.0 (.12) | 11.2 (.44) | 30.5 (1.20) 29.5 (1.16) |
| MPM893***6*** | Ø .4997 (12.692) .4993 (12.682) | .1265 (3.213) .1250 (3.175) | .420 (10.67) | .90 (22.9) Min | .06 (1.6) | .44 (11.2) | 1.20 (30.5) 1.16 (29.5) |
| MPM893***7*** | Ø 14.000 (.5512) 13.985 (.5508) | 5.08 (.200) 5.00 (.197) | 10.90 (.429) | 20.0 (.79) Min | 3.0 (.12) | 11.2 (.44) | 30.5 (1.20) 29.5 (1.16) |

| Model | "H" | "K" | "L" | "L" w/ Brake | "M" | "N" |
|---------------|----------------|--|-------------------|-------------------|----------------------------------|---------------|
| MPM890***6*** | 2.5 (64.0) Max | Ø.223 (5.66) THRU (4) EQ SPD AS SHOWN ON Ø3.875 (98.43) B.C. | 6.49 (164.8) Max | 7.99 (202.9) Max | Ø 2.877 (73.08) 2.873 (72.97) | □ 3.31 (84.1) |
| MPM890***7*** | 64.0 (2.5) Max | Ø7.00 (.276) THRU (4) EQ SPD AS SHOWN ON Ø100.00 (3.937) B.C. | 164.8 (6.49) Max | 202.9 (7.99) Max | Ø 80.00 (3.150) 79.98 (3.149) | □ 89.0 (3.50) |
| MPM891***6*** | 2.5 (64.0) Max | Ø.223 (5.66) THRU (4) EQ SPD AS SHOWN ON Ø3.875 (98.43) B.C. | 7.24 (183.9) Max | 8.74 (222.0) Max | Ø 2.877 (73.08) 2.873 (72.97) | □ 3.31 (84.1) |
| MPM891***7*** | 64.0 (2.5) Max | Ø7.00 (.276) THRU (4) EQ SPD AS SHOWN ON Ø100.00 (3.937) B.C. | 183.9 (7.24) Max | 222.0 (8.74) Max | Ø 80.00 (3.150) 79.98 (3.149) | □ 89.0 (3.50) |
| MPM892***6*** | 2.5 (64.0) Max | Ø.223 (5.66) THRU (4) EQ SPD AS SHOWN ON Ø3.875 (98.43) B.C. | 8.74 (222.0) Max | 10.24 (260.1) Max | Ø 2.877 (73.08) 2.873 (72.97) | □ 3.31 (84.1) |
| MPM892***7*** | 64.0 (2.5) Max | Ø7.00 (.276) THRU (4) EQ SPD AS SHOWN ON Ø100.00 (3.937) B.C. | 222.0 (8.74) Max | 260.1 (10.24) Max | Ø 80.00 (3.150) 79.98 (3.149) | □ 89.0 (3.50) |
| MPM893***6*** | 2.5 (64.0) Max | Ø.223 (5.66) THRU (4) EQ SPD AS SHOWN ON Ø3.875 (98.43) B.C. | 10.24 (260.1) Max | 11.74 (298.2) Max | Ø 2.877 (73.08) 2.873 (72.97) | □ 3.31 (84.1) |
| MPM893***7*** | 64.0 (2.5) Max | Ø7.00 (.276) THRU (4) EQ SPD AS SHOWN ON Ø100.00 (3.937) B.C. | 260.1 (10.24) Max | 298.2 (11.74) Max | Ø 80.00 (3.150) 79.98 (3.149) | □ 89.0 (3.50) |

English = 6
Metric = 7

For Mechanical Dimensions on Termination Option 2 Consult Factory.

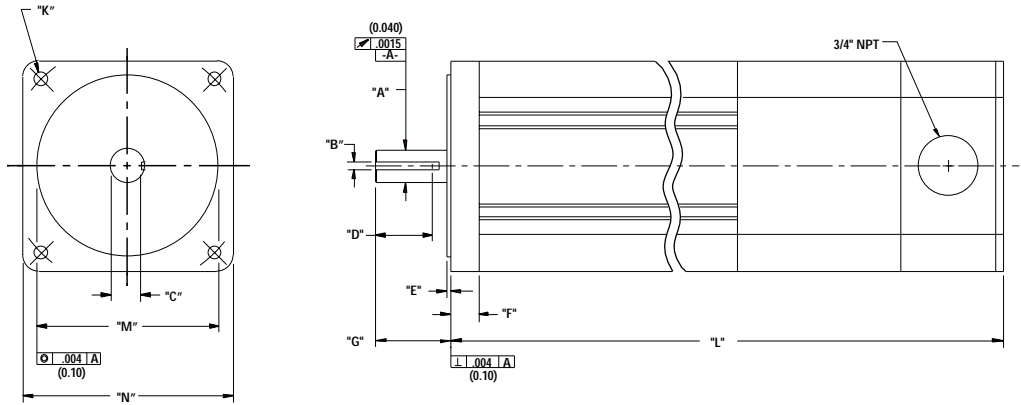

3" (89) English and Metric NPT Termination-Option 3 Motors

| Model | "A" | "B" | "C" | "D" | "E" | "F" | "G" |
|---------------|------------------------------------|--------------------------------|--------------|----------------|-----------|------------|----------------------------|
| MPM890***6*** | ∅ .4997 (12.692) .4993 (12.682) | .1265 (3.213) .1250 (3.175) | .420 (10.67) | .90 (22.9) Min | .06 (1.6) | .44 (11.2) | 1.20 (30.5) 1.16 (29.5) |
| MPM890***7*** | ∅ 14.000 (.5512) 13.985 (.5508) | 5.08 (.200) 5.00 (.197) | 10.90 (.429) | 20.0 (.79) Min | 3.0 (.12) | 11.2 (.44) | 30.5 (1.20) 29.5 (1.16) |
| MPM891***6*** | ∅ .4997 (12.692) .4993 (12.682) | .1265 (3.213) .1250 (3.175) | .420 (10.67) | .90 (22.9) Min | .06 (1.6) | .44 (11.2) | 1.20 (30.5) 1.16 (29.5) |
| MPM891***7*** | ∅ 14.000 (.5512) 13.985 (.5508) | 5.08 (.200) 5.00 (.197) | 10.90 (.429) | 20.0 (.79) Min | 3.0 (.12) | 11.2 (.44) | 30.5 (1.20) 29.5 (1.16) |
| MPM892***6*** | ∅ .4997 (12.692) .4993 (12.682) | .1265 (3.213) .1250 (3.175) | .420 (10.67) | .90 (22.9) Min | .06 (1.6) | .44 (11.2) | 1.20 (30.5) 1.16 (29.5) |
| MPM892***7*** | ∅ 14.000 (.5512) 13.985 (.5508) | 5.08 (.200) 5.00 (.197) | 10.90 (.429) | 20.0 (.79) Min | 3.0 (.12) | 11.2 (.44) | 30.5 (1.20) 29.5 (1.16) |
| MPM893***6*** | ∅ .4997 (12.692) .4993 (12.682) | .1265 (3.213) .1250 (3.175) | .420 (10.67) | .90 (22.9) Min | .06 (1.6) | .44 (11.2) | 1.20 (30.5) 1.16 (29.5) |
| MPM893***7*** | ∅ 14.000 (.5512) 13.985 (.5508) | 5.08 (.200) 5.00 (.197) | 10.90 (.429) | 20.0 (.79) Min | 3.0 (.12) | 11.2 (.44) | 30.5 (1.20) 29.5 (1.16) |

| Model | "K" | "L" | "L" w/ Brake | "M" | "N" |
|---------------|--|-------------------|-------------------|----------------------------------|---------------|
| MPM890***6*** | ∅.223 (5.66) THRU (4) EQ SPD AS SHOWN ON ∅3.875 (98.43) B.C. | 8.00 (203.2) Max | 9.50 (241.3) Max | ∅ 2.877 (73.08) 2.873 (72.97) | □ 3.31 (84.1) |
| MPM890***7*** | ∅7.00 (.276) THRU (4) EQ SPD AS SHOWN ON ∅100.00 (3.937) B.C. | 203.2 (8.00) Max | 241.3 (9.50) Max | ∅ 80.00 (3.150) 79.98 (3.149) | □ 89.0 (3.50) |
| MPM891***6*** | ∅.223 (5.66) THRU (4) EQ SPD AS SHOWN ON ∅3.875 (98.43) B.C. | 8.75 (222.3) Max | 10.25 (260.4) Max | ∅ 2.877 (73.08) 2.873 (72.97) | □ 3.31 (84.1) |
| MPM891***7*** | ∅7.00 (.276) THRU (4) EQ SPD AS SHOWN ON ∅100.00 (3.937) B.C. | 222.3 (8.75) Max | 260.4 (10.25) Max | ∅ 80.00 (3.150) 79.98 (3.149) | □ 89.0 (3.50) |
| MPM892***6*** | ∅.223 (5.66) THRU (4) EQ SPD AS SHOWN ON ∅3.875 (98.43) B.C. | 10.25 (260.4) Max | 11.75 (298.5) Max | ∅ 2.877 (73.08) 2.873 (72.97) | □ 3.31 (84.1) |
| MPM892***7*** | ∅7.00 (.276) THRU (4) EQ SPD AS SHOWN ON ∅100.00 (3.937) B.C. | 260.4 (10.25) Max | 298.5 (11.75) Max | ∅ 80.00 (3.150) 79.98 (3.149) | □ 89.0 (3.50) |
| MPM893***6*** | ∅.223 (5.66) THRU (4) EQ SPD AS SHOWN ON ∅3.875 (98.43) B.C. | 11.75 (298.5) Max | 13.25 (336.6) Max | ∅ 2.877 (73.08) 2.873 (72.97) | □ 3.31 (84.1) |
| MPM893***7*** | ∅7.00 (.276) THRU (4) EQ SPD AS SHOWN ON ∅100.00 (3.937) B.C. | 298.5 (11.75) Max | 336.6 (13.25) Max | ∅ 80.00 (3.150) 79.98 (3.149) | □ 89.0 (3.50) |

English = 6
Metric = 7

For Mechanical Dimensions on Termination Option 2 Consult Factory.

3" Motor with Resolver Feedback

Option 1

Motor Connector 270-00026 (PT02E-14-5P(027))

| Pin | Function | Wire Color |
|-----|----------|------------|
| A | ϕ R | RED |
| B | ϕ S | BLACK |
| C | ϕ T | BLUE |
| D | PE GND | GRN/YEL |
| E | - | - |

Resolver Connector 270-00024 (PT02E-14-18P(027))

| Pin | Function | Wire Color |
|-----|----------|------------|
| U | THERM | BLACK |
| N | THERM | BLACK |
| H | SIN | YELLOW |
| G | COS GND | BLACK |
| S | COS | RED |
| F | SIN GND | BLUE |
| R | REF GND | YEL/WHT |
| E | REF | RED/WHT |
| D | RES SHLD | GRN/YEL |
| P | GND | GRN/YEL |
| A | - | - |
| B | - | - |
| C | - | - |
| J | - | - |
| K | - | - |
| L | - | - |
| M | - | - |
| T | - | - |

* Option 1 with brake

Motor Brake Connector 270-00032 (PT02E-16-8P(027))

| Pin | Function | Wire Color |
|-----|----------|------------|
| A | ϕ R | RED |
| B | ϕ S | BLACK |
| C | ϕ T | BLUE |
| D | PE GND | GRN/YEL |
| E | BRK SHLD | - |
| F | BRK (+) | DIODE |
| G | BRK (-) | 1N4007 |
| H | - | - |

Option 2

Motor Connector 270-00256 (BEGA089NN000009000)

| Pin | Function | Wire Color |
|-----|---------------|------------|
| 1 | ϕ R (U1) | RED |
| 2 | PE GND | GRN/YEL |
| 3 | ϕ T (W1) | BLUE |
| 4 | ϕ S (V1) | BLACK |
| *A | BRK (+) | DIODE |
| *B | BRK (-) | 1N4007 |
| C | THERM | BLACK |
| D | THERM | BLACK |

* USE ONLY WITH BRAKE OPTION

Resolver Connector 270-00257 (AEGA052NN0000013000)

| Pin | Function | Wire Color |
|-----|--------------|------------|
| 1 | - | - |
| 2 | REF (R1) | RED/WHT |
| 3 | REF GND (R2) | YEL/WHT |
| 4 | COS GND (S1) | BLACK |
| 5 | COS (S3) | RED |
| 6 | SIN (S2) | YELLOW |
| 7 | SIN GND (S4) | BLUE |
| 8 | - | - |
| 9 | - | - |
| 10 | - | - |
| 11 | - | - |
| 12 | - | - |

Option 3

Connection Chart (NPT) Resolver

| Terminal | Function | Wire Color | Terminal | Function | Wire Color |
|----------|----------|------------|----------|----------|------------|
| 1 | ϕ R | RED | S9 | REF GND | YEL/WHT |
| 2 | ϕ S | BLACK | S8 | REF | RED/WHT |
| 3 | ϕ T | BLUE | S7 | SIN | YELLOW |
| - | PE GND | GRN/YEL | S6 | COS | RED |
| *S11 | BRK (+) | BLUE | S5 | COS GND | BLACK |
| *S10 | BRK (-) | BLUE | S4 | SIN GND | BLUE |
| | | | S3 | THERM | BLACK |
| | | | S2 | THERM | BLACK |
| | | | S1 | RES SHLD | GRN/YEL |

* USE ONLY WITH BRAKE OPTION

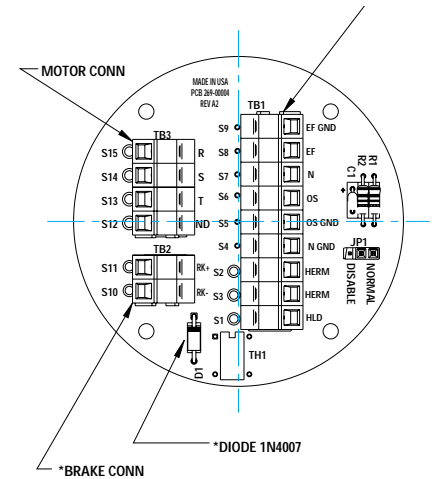

3" Motor with Encoder Feedback

Option 1

Motor Connector 270-00026 (PT02E-14-5P(027))

| Pin | Function | Wire Color |
|-----|----------|------------|
| A | ϕ R | RED |
| B | ϕ S | BLACK |
| C | ϕ T | BLUE |
| D | PE GND | GRN/YEL |
| E | - | - |

Encoder Connector 270-00024 (PT02E-14-18P(027))

| Pin | Function | Wire Color |
|-----|-----------|------------|
| T | GND | BLACK |
| K | +5VDC | RED |
| B | CH A | BLUE |
| C | CH A\ | BLUE/BLK |
| N | CH B | GREEN |
| P | CH B\ | GRN/BLK |
| M | CH Z | YELLOW |
| U | CH Z\ | YEL/BLK |
| E | CH U | BROWN |
| R | CH U\ | BRN/BLK |
| F | CH V | GRAY |
| S | CH V\ | GRAY/BLK |
| G | CH W | WHITE |
| H | CH W\ | WHT/BLK |
| D | GND/CABLE | SHLD |
| A | THERM | BLACK |
| L | THERM | BLACK |
| J | GND | GRN/YEL |

Option 1 with brake

Motor Brake Connector 270-00032 (PT02E-16-8P(027))

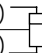
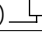
| Pin | Function | Wire Color |
|-----|---|------------|
| A | ϕ R | RED |
| B | ϕ S | BLACK |
| C | ϕ T | BLUE |
| D | PE GND | GRN/YEL |
| E | BRK SHLD | - |
| F | BRK (+)  | DIODE |
| G | BRK (-)  | 1N4007 |
| H | - | - |

Option 3-Consult Factory

Option 2

Motor Brake Connector 270-00256 (BEGA089NN00000013000)

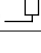
| Pin | Function | Wire Color |
|-----|---|------------|
| 1 | ϕ R (U1) | RED |
| 2 | PE GND | GRN/YEL |
| 3 | ϕ T (W1) | BLUE |
| 4 | ϕ S (V1) | BLACK |
| *A | BRK (+)  | DIODE |
| *B | BRK (-)  | 1N4007 |
| C | THERM | BLACK |
| D | THERM | BLACK |

* USE ONLY WITH BRAKE OPTION

Encoder Connector 270-00257 (AEGA052NN00000013000)

| Pin | Function | Wire Color |
|-----|--------------|------------|
| 1 | GND (OV) | BLACK |
| 2 | CH A\ A | BLUE/BLK |
| 3 | CH A (A\) | BLUE |
| 4 | CH B (B) | GREEN |
| 5 | CH B\ (B\) | GRN/BLK |
| 6 | CH Z (Z) | YELLOW |
| 7 | CH Z\ (Z\) | YEK/BLK |
| 8 | +5V (+5V) | RED |
| 9 | - | - |
| 10 | CH U (RLG U) | BROWN |
| 11 | CH V (RLG V) | GRAY |
| 12 | CH W (RLG W) | WHITE |