

MOTOR DATA @ 48 VDC (TRAP)

MOTOR PARAMETERS	UNITS	VALUE
HORSEPOWER	HP	0.9
KILOWATTS	KW RATED	0.7
MAX. OPERATING SPEED	N. MAX RPM	4375
SPEED @ RATED TORQUE	N RATED RPM	3500
* CONTINUOUS RATED TORQUE @ 3500 RPM	N-LBS [Nm]	16.6 [1.88]
* CONTINUOUS STALL TORQUE	N-LBS [Nm]	18.8 [2.12]
CONTINUOUS LINE CURRENT	AMPS	3.2
PEAK TORQUE	TPK N-LBS [Nm]	56.0 [6.4]
PEAK CURRENT	AMPS	9.7
MAX. THEORETICAL ACCEL.	RAD/SEC ²	110,000
TORQUE SENSITIVITY	Kt N-LB/AMP [Nm/AMP]	5.82 [0.658]
BACK EMF (LINE TO LINE)	±10% Vrms/Krpm	51.8
D.C. RESISTANCE (P-P)	±10% OHMS	5.5
INDUCTANCE (P-P)	±10% MILLIHENRIES	13.0
ROTOR INERTIA	Jm [N-LBS-SEC ²] Kg-M ²	0.00049 [0.000055]
STATIC FRICTION	Tf N-LBS [Nm]	1.2 [0.14]

*25°C AMBIENT WITH A MAXIMUM CASE TEMPERATURE OF 85°C ON MOTOR. MOTOR MOUNTED ON A 1/2" X 1/2" X 1/2" ALUMINUM HEATSINK. THERMOSTAT IN STATOR WINDINGS WILL OPEN IF WINDING TEMPERATURE EXCEEDS 155°C. THIS ALLOWS FOR AN APPROXIMATE +10% HEADROOM IN THE CONTINUOUS TORQUE RATING BEFORE THERMOSTAT OPENS.

MECHANICAL NOTES:

- AXIAL LOAD: 20 LBS MAX
- RADIAL LOAD: 35 LBS MAX @ 1" FROM FACE
- MOTOR SEALED TO IP65.
- MOTOR WEIGHT: 5.9 LBS. [2.7 Kg]
- MOTOR FINISH: BLACK EPOXY
- MOTOR OUTPUT SHAFT: STAINLESS STEEL
- MILLIMETERS (INCHES)
- THIS MOTOR'S OUTPUT KEY IS A PRESS FIT.

ENCODER: (290-00155)

OH35-1000P6-L6-5V

CONNECTION CHART MOTOR/ENCODER/THERM CONNECTOR: PT02E-16-23P(027) (270-00219)

ENC/THERM WIRE LEADS	WIRE FUNCTION	WIRE COLOR
T	GROUND	BLACK
E	+5VDC	RED
F	CH A	BLUE
U	CH A	BLUE/BLK
G	CH B	GREEN
V	CH B	GRN/BLK
H	CH Z	YELLOW
W	CH Z	YEL/BLK
J	CH U	BROWN
K	CH U	BRN/BLK
X	CH V	GRAY
L	CH V	GRAY/BLK
Y	CH W	WHITE
M	CH W	WHT/BLK
N	GND/CABLE	SHLD
S	THERM	BLACK
R	THERM	BLACK
P	-	-
Z	-	-

MOTOR WIRE LEADS	WIRE FUNCTION	WIRE COLOR
A	ΦR	RED
B	ΦS	BLACK
C	ΦT	BLUE
D	PE GND	GRN/YEL

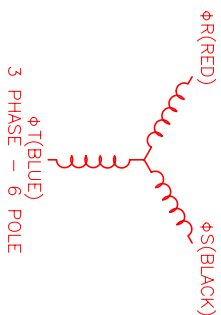

*MOTOR ROTATION CCM (COUNTER CLOCKWISE)
(LOOKING AT THE FACE OF THE MOTOR)

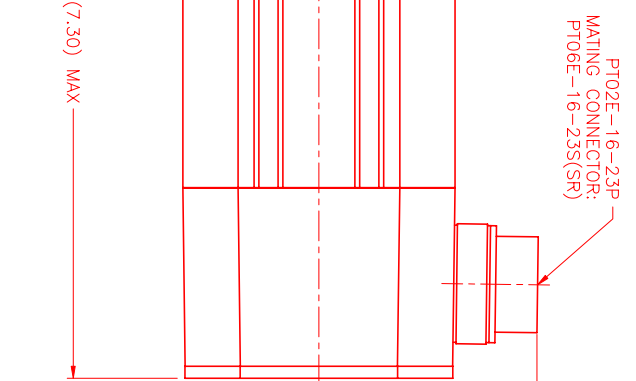
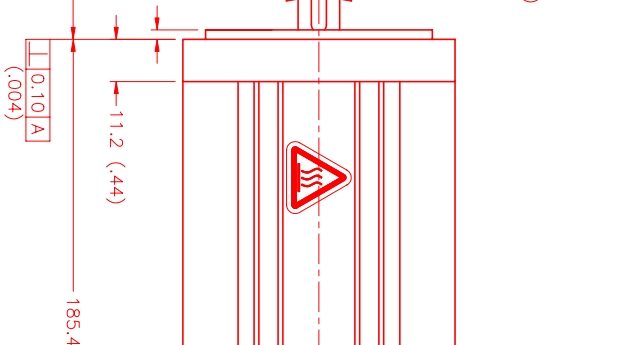
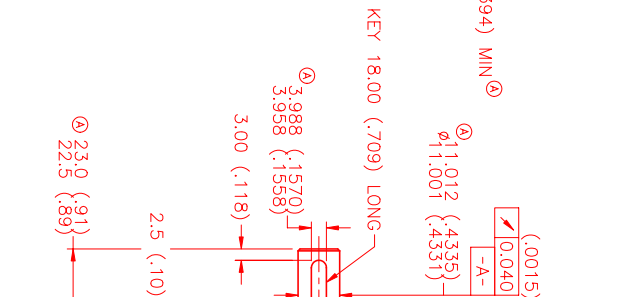
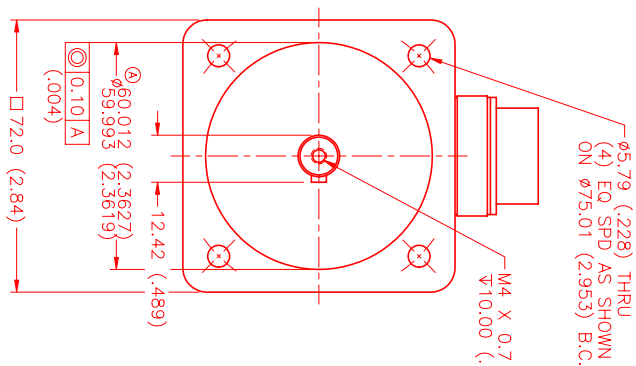

TITLE: C / P / 4800C / MET / T1 / CONN DRAWING NUMBER: MPM724CTL7JM1N		REVISIONS DATE: 3/12/99 APP'D: LIN DESCRIPTION: PRELIMINARY DATE: 2/2/00 APP'D: AJS E.C.O. - 558	
NO. PART NUMBER	DESCRIPTION	QTY.	
UNLESS SPECIFIED			
DECIMAL ANGLES ± .005			
DECIMAL ANGLES ± .010			
DECIMAL ANGLES ± .020			
DECIMAL ANGLES ± .050			
DECIMAL ANGLES ± .125			
DATE: 3/12/99	TITLE: "C" / TRAP / 48VDC / MET / T1 / CONN	REV: A	
DRAWN: LIN	CHECKED:	APPROVED:	
MTS Automation Division MTS Systems Corporation 10000 W. 16th Ave., Suite 100 Golden, CO 80401 PHONE: 303.440.9300 FAX: 303.440.9301 WWW: www.mtsautomation.com		SCALE: 1:1	